

Domestic waste water disposal unit with floor-mounted collecting tank.

Saniquick B and BT

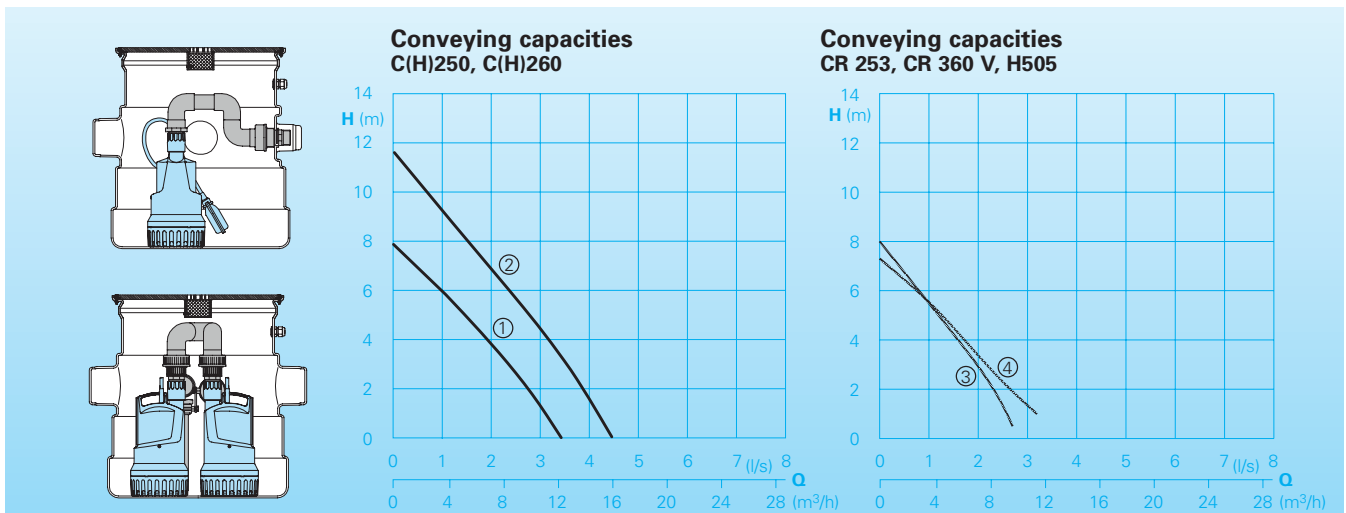

Application

Homa Saniquick B and BT are used for removal of domestic waste water from hand basins, washing machines and cellar de-watering in rooms below the sewer level. Installation in cellars, basements and baths.

DIN EN 12050-2: Conformity and design approved and controlled by LGA

Installation: Floor mounted collecting tank with odour-tight cover plate.

Conveying medium: Clear water and domestic waste water. Max. liquid temperature: 35°C, short term up to 60°C.

Construction

Waste water disposal unit consisting of:

Collecting tank:

Plastic tank, volume 40 l, with 3 inlets DN 100. Connecting piece DN 70 for optional air vent. Cover plate with odour trap and activated carbon filter.

Pump/Motor:

One single stage centrifugal submersible drainage pump (model B) or two single stage centrifugal submersible drainage pumps (model BT). Fully submersible motor, 230V/1Ph. Insulation class B/F, Degree of protection IPX8. C250, C260, CR253, H505: Open multi-channel impeller, spherical clearance 10 mm dia. CR360V: vortex impeller, spherical clearance 20 mm dia.

Technical Data

Curve No	Pump type	Motor		Nominal current (A)	Weight (kg)
		P ₁ (kW)	P ₂ (kW)		
①	Saniquick B – C250WA	0,55	0,26	2,5	13,3
②	Saniquick B – C260 WA	0,90	0,48	4,0	15,0
③	Saniquick B – CR 253 WA	0,53	0,34	2,1	13,2
④	Saniquick B – CR 360 V WA	0,63	0,45	2,9	15,9
<hr/>					
①	Saniquick BT – C250 W	0,55	0,26	2,5	21,5
④	Saniquick BT – CR 360 V W	0,63	0,45	2,9	23,0

Speed: 2900 rpm

Pressure connection: G 1¼ F

Model W: 230V/1Ph 50Hz

Model B: Single pump lift station

Model BT: Twin pump lifting station

Materials

Collecting tank	Polyethylene
Installation kit	PVC
Pump housing	
C(H)250 - C(H)260:	Impact resistant plastic
CR 253, CR 360V:	Stainless steel
Motor housing	
CH250 - CH260	Stainless steel
	high resistant stainless steel
Impeller	
C250 - C260:	Impact resistant plastic
CR 253, CR 360V:	Stainless steel
Motor shaft, screws	
CH250 - CH260	Stainless steel
	high resistant stainless steel
Elastomers	NBR

Control box: Model B (1 pump) with float switch. Model BT (2 pumps) with electronic control box for control and monitoring of all important functions. Pneumatic level control with pressure operation. Auto-change over after each pump cycle. Operation of both pumps at high flow. In the event of failure automatic change over to the second pump. Motor protection relay. Optical failure alarm. Acoustic alarm by buzzer. Volt free contact for remote signal. Connection for ServCom controller (see accessories). Mains-independent alarm by installing a 9V battery (see accessories).

Installation Example

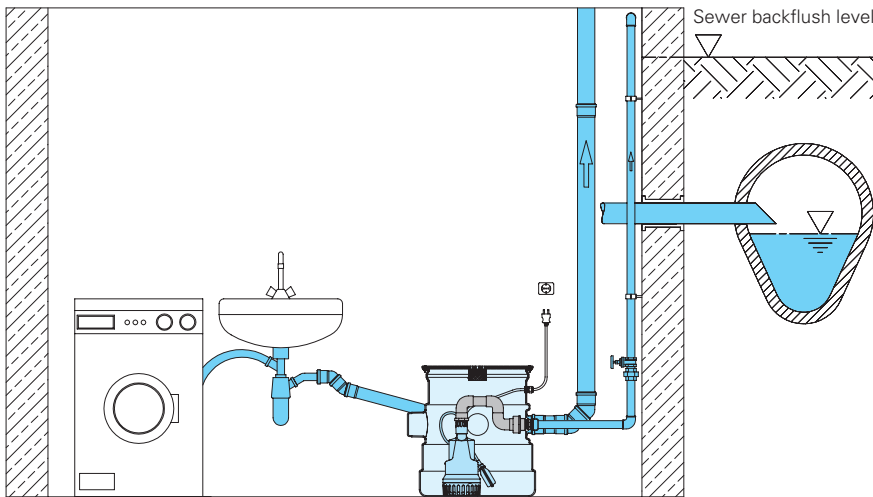

Scope of supply Saniquick B

Saniquick B

collecting tank, 1 pump with float switch, non-return-valve and discharge pipe, 3 m of cable and plug.

Type	Part No.
Saniquick B – C250 WA	9804130.01
Saniquick B – C(H)260 WA	9804131.01
Saniquick B – CR 253 WA	9804132.01
Saniquick B – CR 360 V WA	9804134

Scope of supply Saniquick B (T)

Saniquick BT

collecting tank with 2 pumps with non-return-valve and discharge pipe, 3 m of cable and plug, control box with pneumatic level control and alarm device

Type	Part No.
Saniquick BT – C250 W	9804146.01
Saniquick BT – CR 360 V W	9804148

Accessories Saniquick B (T)

Type	Part No.
2 Poles earth leakage circuit breaker Fi 16/0,03 A	1561160
Alarm control unit AL3 with reservoir float	1586146
Alarm control ALWS with reservoir float and washing machine stoppage	1586213
rechargeable battery, 9 V	1952215
Version with additional pump types	on demand

Dimensions (all dimensions in mm)

Collecting tank

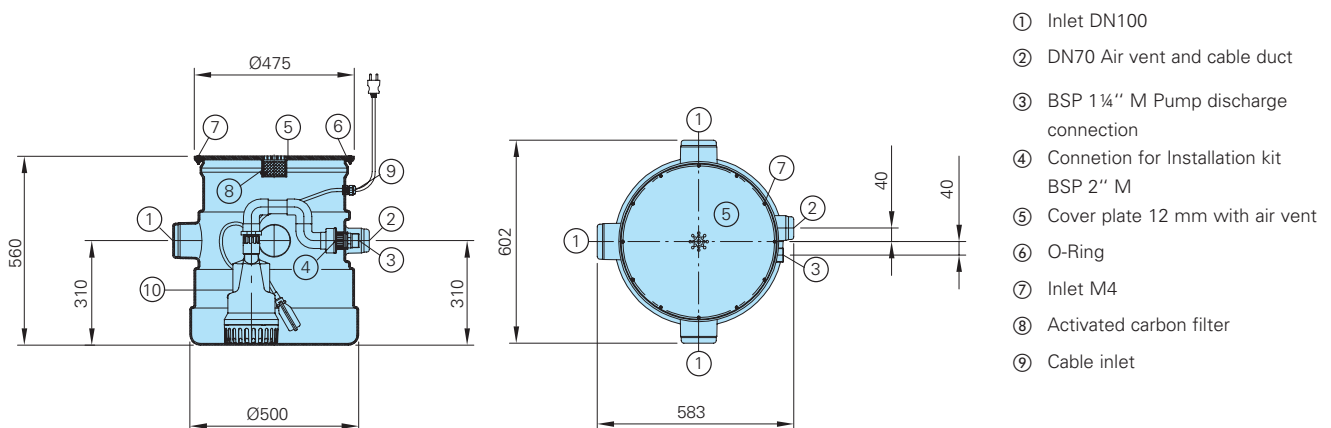

HOMA
P U M P T E C H N O L O G Y

HOMA Pumpenfabrik GmbH
P.O.Box 22 63, D-53814 Neunk.-Seelscheid
Tel. +49 (0) 22 47 / 702-0, Fax +49 (0) 22 47 / 702-44
e-mail: info@homa-pumpen.de
www.homapumps.com